



GENUINE PARTS & ACCESSORIES



## 06-157 CRUISE STEERING WHEEL INSTALLATION INSTRUCTIONS

### ITEMS INCLUDED

- STEERING WHEEL
- STEERING WHEEL COVER
- STEERING WHEEL ADAPTER BUSHINGS (SET OF 3)
- FENDER WASHER
- STEERING COLUMN COVER CLAMSHELL
- 2 PHILLIPS HEAD SCREWS

### TOOLS NEEDED

- 15/16" (or 24mm) Socket
- Phillips Head Screwdriver
- Torque Wrench
- Rubber Mallet/Deadblow

#### STEP 1:

Make sure wheels are pointed straight.

#### STEP 2:

Remove OEM steering wheel cover.



### STEP 3:

Using socket, remove the steering wheel nut from steering column.



### STEP 4:

Remove existing steering wheel from steering column. This may require some wiggling or encouragement using the deadblow mallet.

**NOTE: Take care not to damage hard plastic parts.**



### STEP 5:

Select the correct steering wheel adapter bushing for your cart.

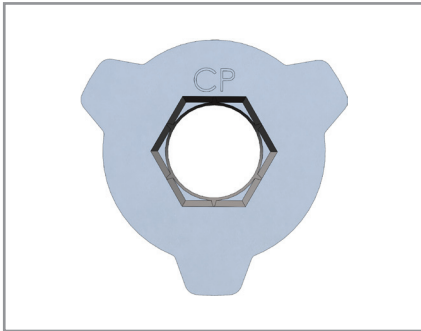

**CLUB CAR®**

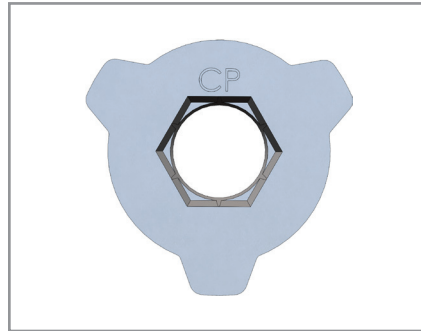

**E-Z-GO®**

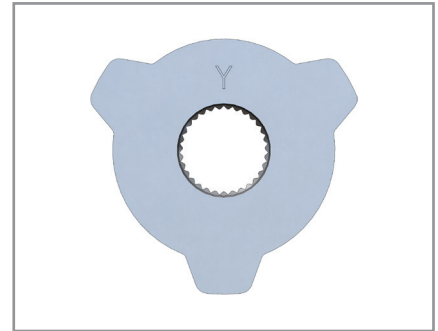

**YAMAHA®**

### STEP 6:

Put adapter bushing on steering column splines with the widest end of the taper downwards. To keep the steering wheel best aligned with the wheels, the adapter ears should be in a 'y' orientation with the bottom ear pointing to the '6 o'clock' position.



## STEP 7:

Slide the MadJax® steering wheel onto the adapter, followed by the provided fender washer and factory lock nut.

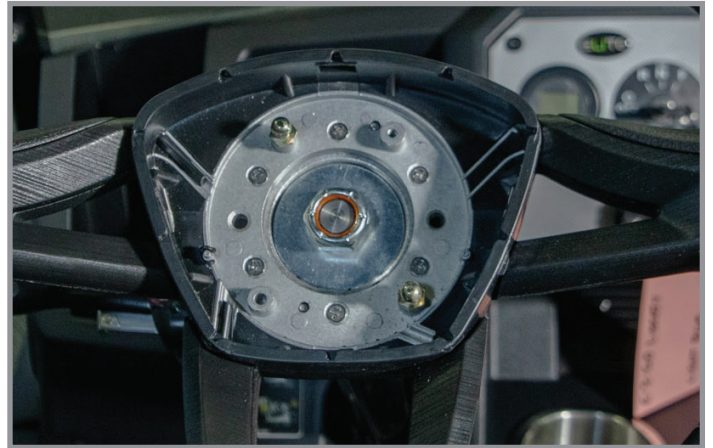

## STEP 8:

Using the socket, tighten the locknut until just snug.

**NOTE: \*\*Do not overtighten\*\***

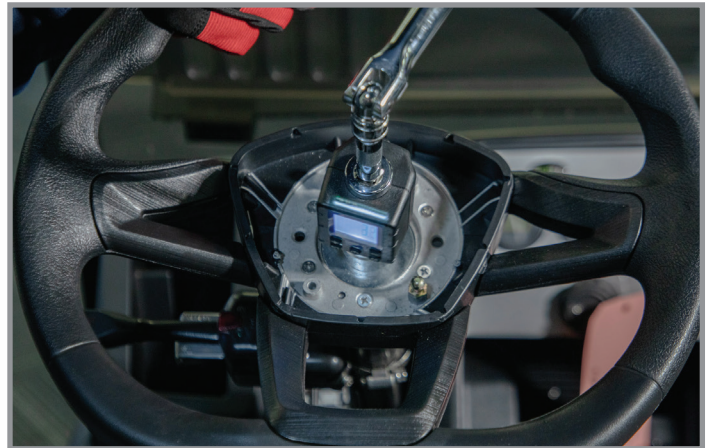

### STEP 9:

Before replacing the steering wheel cover, test drive in a safe area to check steering wheel alignment. If the steering wheel isn't quite aligned, loosen the lock nut and gently slide the steering wheel and bushing off of the steering column and re-seat to adjust.

### STEP 10:

Once satisfied with steering wheel alignment, tighten the lock nut to 18 ft-lbs of torque using the torque wrench.



### STEP 11:

Place the steering wheel center cover on to the center of the steering wheel. Gently apply pressure at each corner with the palm until that corner clicks into place.



## STEP 12:

Slide the steering column cover clamshell over the base of the steering wheel. Ensure that the holes are towards the passenger side of the cart. Secure with provided Phillips head screws.



**INSTALLATION COMPLETE**